



# ASTERIE - PSV

FiFi I DP1 Platform Support Vessel

3,227 t deadweight



ASTERIE is a UT 755L design, DPI, FIFI 1, platform supply vessel.

The vessel is designed for world-wide, deep water operations to fulfill the following duties:

- Transportation of liquid products, deck cargo and other equipment for drilling and production support.
- Methanol transportation.
- ROV operations.

« Photo: «ANTENOR» Sistership of «ASTERIE».

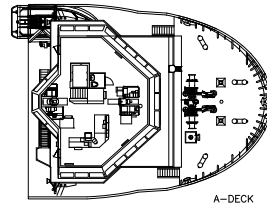

A-DECK

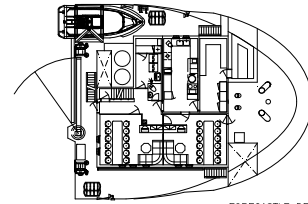

FORECASTLE DECK

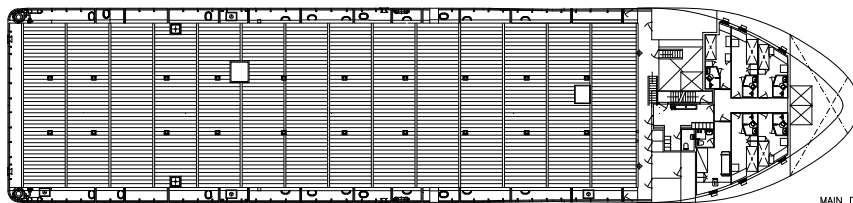

MAIN DECK

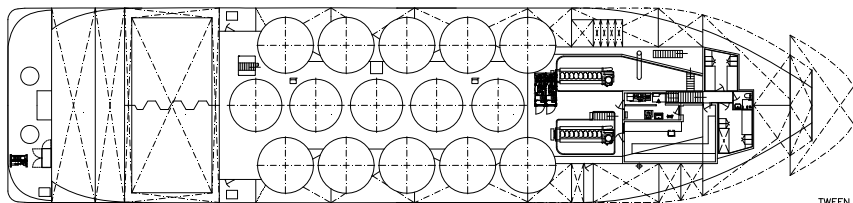

TWEEN DECK

PLATFORM SUPPLY VESSEL

## REGISTRATION

Vessel Name: **ASTERIE**  
 Type: **DP1 PSV Ulstein design UT 755 L.**  
 Year: **2003**  
 Owner: **Bourbon Surf**

Builder: **AKER BRATTVAAG (Norway)**  
 Class: **DNV + 1A1, SF, DYNPOS-AUT EO dk(+) hl (2,5), Fi-Fi I.**  
 Flag: **French**

Updated: 26-06-2009





### • MAIN PARTICULARS

#### DIMENSIONS

Length overall:	72.00 m
Breadth moulded:	16.00 m
Depth:	7.00 m
Draft:	5.90 m
Deadweight:	3,227 t
Gross tonnage:	2 641
Net tonnage:	648

#### CAPACITIES

Deck area:	(51.00m x 13.50m) 688 m2
Deck cargo:	1,600 t
Fuel oil:	1,200 m3
Drill water:	1,250 m3
Fresh water:	590 m3
Liquid mud:	1,200 m3
Brine:	1,000 m3
Base oil:	200 m3
Dry Bulk/Cement:	318 m3
Dispersant:	14 m3
Foam:	28 m3
Methanol (optionnal):	200 m3

#### DELIVERY RATES

Fuel oil:	200 m3/h at 9 bars
Drill water:	150 m3/h at 9 bars
Fresh water:	200 m3/h at 9 bars
Liquid mud:	2x 100 m3/h at 18 bars
Brine:	75 m3/h at 18 bars
Base oil:	200 m3/h at 9 bars
Dry Bulk/Cement:	2x 22.7 m3/h at 5.6 bars
Methanol:	2x 75 m3/h at 9 bars

#### ACCOMODATIONS

Accommodations for:	32 pers
Single cabins:	10
2 man cabins:	5
4 man cabins:	3
Hospital:	1
Mess / Day rooms:	2
Fully air-conditionned.	

### • MACHINERY / PERFORMANCE

#### PROPULSION - MACHINERY

Main engines:	2 x 2,040 kW
Propellers:	2 with CCP
Bow thruster:	590 kW Tunnel
Stern thruster:	590 kW Tunnel
Azimuth thruster forward:	590 kW
Rudders:	2 independent rudders with flaps
Shaft generators:	2 x 1,800 kVA at 1,800 rpm
Auxilliary generators:	2 x 250 kW at 1800 rpm
Emergency generator:	62 kW at 1,800rpm

#### SPEED / CONSUMPTION

Maximum speed (100%):	20 m3/day at 14 knots
Service speed (80%):	16 m3/day at 12 knots
Economic speed (50%):	9 m3/day at 10 knots

### • EQUIPMENT & ELECTRONICS

#### DYNAMIC POSITIONING SYSTEM

Type:	Class DP1
- Sensors and monitoring as per class I requirements	
- 1 moon pool for later installation of a Hipap	

#### DECK EQUIPMENT

Tuggers:	2 x 10 t
Capstans:	2 x 8 t
Deck provisions crane:	3 t at 16 m
Fire Fighting (Fifi 1):	2 pumps of 1,600 m3/h 2 monitors of 1,200 m3/h
MOB boat with davit.	

#### ELECTRONICS

##### - NAVIGATION

2 radars
1 gyrocompass
1 digital echo-sounder
1 speed log
1 autopilot system
1 GPS

##### - COMMUNICATION

1 radio system compliant with GMDSS A3
1 Inmarsat B
1 weather fax

*All particulars believed to be correct but not guaranteed*